



Technical specification

Siren

Type:
Siren

Ordering code:
CKNPGD1

Date: 13.03.2018
Document: Cockpit SL_Siren_User Manual_eng

Siren module is part of Your Cockpit system.

The purpose of Siren is to warn people in the building by a loud sound and a flashing light (strobe) that an alarm has occurred.

The Siren integrates both functions of Siren and strobe into one unit. When it receives a wireless command, it will either activate the sound and flash lights or stop its visual and audible alarm indications.

Product Overview

LED setting Light

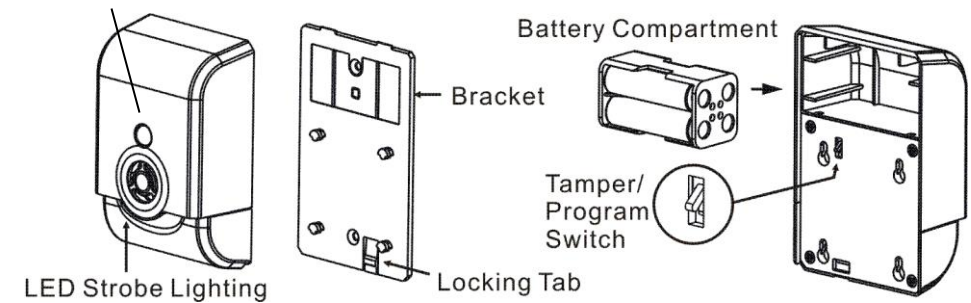

Include or Exclude from the Network

Inclusion: adding Siren to a network. Put Cockpit into “inclusion” mode, and following instruction how to add Siren to your Cockpit controller. Bring Siren in a distance of maximum one meter from the Cockpit. Open the bracket and press the program switch for 1 second at least & release to be included. After setting, the LED Setting Light should go off. If not, please try again.

Exclusion: removing Siren from a network. Put Cockpit into “exclusion” mode, and following instruction how to delete the Siren from your Cockpit controller. Bring Siren in a distance of maximum one meter from the Cockpit. Press the program switch for 1 second at least & release to be excluded.

Note: LED setting light will flash continuously in Exclusion condition.

Configuration parameters:

Parameter 1: Siren/ Strobe Mode, 1 Byte Value: 0=Siren and Strobe enable (default), 1=Siren only, 2= Strobe only.

Parameter 2: Alarm auto stop time command, 1 Byte Value: 0=30 seconds (default), 1= 60 secs, 2= 120 secs, 3=Siren will not automatically stop.

Installation

The Siren is suitable for mounting in dry interior locations only. Please follow these directions when first setting up, or for the purpose of battery replacing.

1. Remove the bracket from the Siren by press the locking tab, and then gently slide up the Siren. Observe the correct polarity before insert the batteries.
2. Using the screws or adhesive tape to affix the bracket on the chosen location.
3. Slide back the front cover, and then the LED should go off.

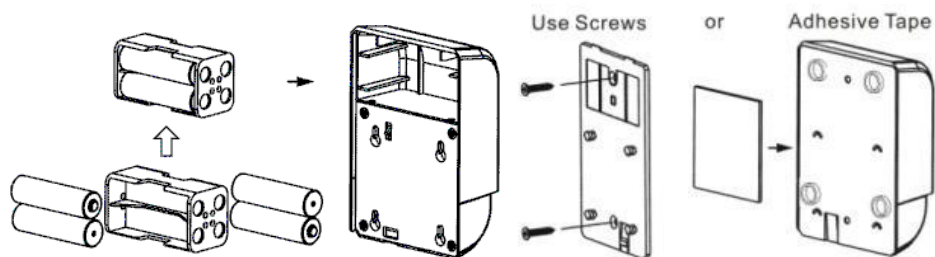

Operation

1. Normal operation, the LED light will be off.
2. Self-Protection Mode: After put back the bracket over 5 seconds, Siren will enter Self-Protection Mode which will active LED Strobe and Light & Siren at the same time. The Alarm mode will be triggered if the back cover has been opened during the Self-Protection Mode.
3. Alarm Mode (status of alarm triggered): based on the user's configuration setting for LED strobe (ON/OFF) and Siren (ON/OFF).
Note: by default setting-Siren/Strobe Mode-Parameter will be both enable; Alarm Auto Stop Time-Parameter will be 30 sec.
4. For safety reason, replace new battery whenever Siren is triggered.

Important disclaimer

This product uses radio to wirelessly communicate data between itself and other devices. Radio communication is inherently not always 100% reliable, and as such, this product should not be used in situations in which life and/or valuables are solely dependent on its function.

Warning!

Do not dispose of electrical appliances as unsorted municipal waste, use separate collection facilities.

Contact your local government for information regarding the collection systems available. If electrical appliances are disposed of in landfills or dumps, hazardous substances can leak into the groundwater and get into the food chain, damaging your health and well-being. When replacing old appliances with new once, the retailer is legally obligated to take back your old appliance for disposal at least for free of charge

Technical Specification

Power supply	4xAA batteries
Frequency Range	868.42 MHz
Sound level	105dB
Auto stop	Yes (after 30 seconds)
Operation temperature	-15 ~ 60°C
Operation Range	up to 30m indoor
Dimensions (WxHxD)	116mm x 77mm x 40mm
Weight	130 g

*** Specifications are subject to change and improvement without notice.*



Cockpit Smart Home d.o.o.

Ulica Klementa Juga 007

5250 Solkan, Slovenia

Web: www.yourcockpit.biz

Tel: +386 5 335 95 00