



A/C control

Ordering code:

CKNPCD1

A/C control module is part of Your Cockpit system.

The purpose of A/C control module is translating wireless commands to AC IR control code. A/C control module is IR extender (Figure 1) for air-conditioner (AC) control over COCKPIT. User can select the IR code table from the built-in code library for different air-conditioner models.

A/C control module has built-in temperature sensor, so user can get the current room temperature information as feedback.

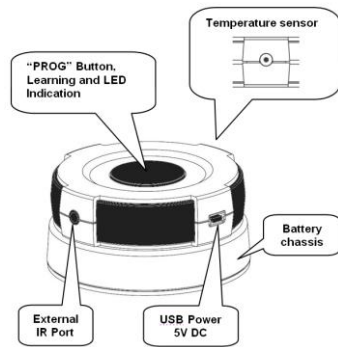

Include/ Exclude A/C control module to/from the Network

In the centre of A/C control module is a "Prog" button which have a function to carry out the inclusion/exclusion radio signal with combination of pressures.

Including/Excluding procedure

Function	Description
Inclusion	Include a wireless enabled device (e.g. A/C control) to the network.
Exclusion	Exclude a wireless enabled device (e.g. A/C control) from the network.

Built-in IR code library

The Built-in IR code library supports different air-conditioner models. During the installation should be selected right code-set table for related air-

conditioner.

Code-set table selection procedure

When A/C control module is part of network, could be set code-set table for air-conditioner which you want to control.

Follow next steps:

- Open A/C control unit service page (tool icon on right/top corner)
- Select "Device options"
- Click to "Add configuration settings" to set parameter 27
- Set variable 27:
 - o Type to variable location: 27
 - o Data size: 1 byte dec
 - o Desired value: code-set number for related air-conditioner
- Save set data, click to reload and check if set data have been accepted (in the same window)

A/C control is battery operated module. It enters to sleep mode frequently in order to conserve battery consumption.

Reset A/C control to factory default

Press and hold "Prog" button for 10 sec on A/C control. The LED will flash twice until reset process is completed!

Note: This reset step will not affect the operation mode of A/C control, user should refer to "Listening mode" section if want to change the operation mode!

A/C control Operations

Before using the A/C control module, please read chapter "Installation" (next page) if you need to mount the A/C control to a wall. A/C control could be powered by the USB Power 5Vdc or Dry battery AAA x 3pcs.

- Plug-in 5Vdc power into the USB socket if operated at Always Listening mode.
- Install 3xAAA batteries
- Please refer to the section of "Mounting procedure" (next page).
- Remove the battery cover on the back of your A/C Control battery chassis.
- Mount the battery cover into the main unit with 2 screws.
- Check the polarity of the batteries and the "+/-" marks inside the battery compartment.
- Insert the batteries.
- Push the battery cover and main unit back in place.

ⓘ CAUTION (battery and power adaptor safety)

- Use new batteries of the recommended type and size only.
- Never mix used and new batteries together.
- To avoid chemical leaks, remove batteries from the A/C Control if you do not intend to use the remote for an extended period of time.
- Dispose of used batteries properly; do not burn or bury them.

(Please carefully read through the following then store the manual for future reference.)

Choosing A Mounting Location

- Do not mount near a kitchen counter, humidifier, or other location in which it can be exposed to smoke or steam. Doing so could cause a fire or electrical shock.
- Do not mount in locations with high humidity or large amounts of dust. Doing so could cause a fire or electrical shock.
- Do not mount to locations subject to high temperatures, high humidity, or exposure to water. Doing so could cause a fire or electrical shock.
- Do not mount to locations subject to large amounts of vibration, large jolts, or large forces. These could cause an injury if the A/C CONTROL falls and breaks.

Installation

The A/C control module can be mounted to a wall or wooden racks using the two key holes in the bottom case.

Note 1: The reception sensitivity varies depending on the antenna direction.
Note 2: Before mounting to a wall, be sure to fully read the precautions.

1. Obtain two screws suitable for the wall strength and material. The screw size is shown in the figure below.

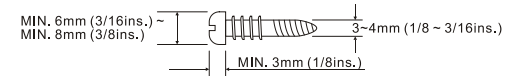

2. The positional relationship between the A/C control key holes and the screw mounting positions are shown in the figure below.

Note 1: When mounting the screws to the wall, leave a space between the wall and screw cap as shown in the figure.

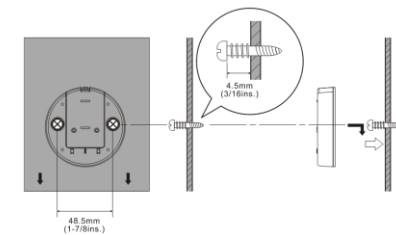

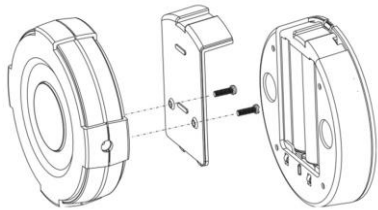

3. Insert the A/C control key holes onto the two screws mounted to the wall, and then slide downward to secure in place.
 4. After securing the A/C control to the wall, connect the USB Power or batteries and IR emitter cable to the A/C control.
- Note 1:** Check that the A/C control is firmly secured to the wall.
Note 2: Insert USB plug or batteries and IR emitter cable so that they are firmly connected to the A/C control.
5. When removing the A/C control from the wall, lift up the A/C control, then pull it towards you.
 6. Detach the main unit from the battery chassis by move toward to top position.

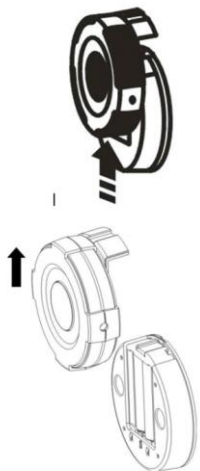

Operation

This device has an open-air line-of-sight transmission distance of 30 meters. Performance can vary depending on the amount of objects in between devices such as walls and furniture. Each device set up in your network will act as a signal repeater allowing devices to talk to each other and find alternate routes in the case of a reception dead spot.

Radio frequency limitations:

1. Each wall or object (i.e.: refrigerator, bookshelf, large TV, etc) can reduce the maximum range of 20 meters by up to 25 to 30%.
2. Plasterboard and wooden walls block less of the radio signal than concrete, brick or tile walls which will have more of an effect on signal strength.
3. Wall mounted devices will also suffer a loss of range if they are housed in metal junction boxes which could also reduce the range by up to 25% - 30%.

Maintenance

- 1 Do not expose your A/C control to dust, strong sunlight, humidity, high temperatures or mechanical shocks.
- 2 Do not use old and new batteries together as old batteries tend to leak.
- 3 Do not use corrosive or abrasive cleansers on your A/C control.
- 4 Keep the unit dust free by wiping it with a soft, dry cloth.
- 5 Do not disassemble your A/C control, it contains no user-serviceable parts.

Technical Specifications

Ordering code	YOUR COCKPIT ordering code
RF frequency	868.4MHz (EU) (A/C CONTROL EU)
RF operating distance	up to 25m outdoor line of sight, in unobstructed environment
IR operating distance	up to 8m line of sight, in unobstructed environment
Temperature	Measurable range: 0 – 40 °C Operation: 0 - 40°C Storage: -20 - 60°C
Powered by	USB Power DC 5V 100mA or Dry battery AAA x 3pcs
Dimension	Dia.=70mm, Thick. = 18mm (Main unit) Dia.=70mm, Thick. = 15.5mm (Battery chassis)
Weight	35g (Battery chassis excluded) 60g (Battery chassis included) 90g (Main + Battery chassis + AAA x3pcs)

WARNINGS: Changes or modifications not approved by the party responsible for compliance could void the user's authority to operate the equipment:

- RISK OF FIRE
- RISK OF ELECTRICAL SHOCK
- RISK OF BURNS
- The socket-outlet shall be installed near the equipment and shall be easily accessible.
- Use only power supplies listed in the user instructions.

CAUTION

- RISK OF EXPLOSION IF BATTERY IS REPLACED BY AN INCORRECT TYPE.
- DISPOSE OF USED BATTERIES ACCORDING TO THE INSTRUCTIONS.



WARNING:

Do not dispose of electrical appliances as unsorted municipal waste, use separate collection facilities.

Contact your local government for information regarding the collection systems available.

If electrical appliances are disposed of in landfills or dumps, hazardous substances can leak into the groundwater and get into the food chain, damaging your health and well-being.

When replacing old appliances with new ones, the retailer is legally obligated to take back your old appliance for disposal free of charge.

Cockpit Smart Home d.o.o.

Ulica Klementa Juga 007

5250 Solkan, Slovenia

Web: www.yourcockpit.biz

Tel: +386 5 335 95 00

Date: 13.03.2018

Document: Cockpit SL_AC Control user manual_V1.3B_eng